

# B4WBVILLAEXP

4' VILLA STYLE BENCH W/BACK  
PORTABLE DESIGN

## **FURNITURE LEISURE INC**

### OUR LIST OF WEB STORES

[www.FurnitureLeisure.com](http://www.FurnitureLeisure.com)

[www.PicnicFurniture.com](http://www.PicnicFurniture.com)

[www.ParkTables.com](http://www.ParkTables.com)

[www.PoolFurnitureSupply.com](http://www.PoolFurnitureSupply.com)

[www.PicnicTableSupplier.com](http://www.PicnicTableSupplier.com)

[www.UBrace.com](http://www.UBrace.com)

**1.800.213.2401**

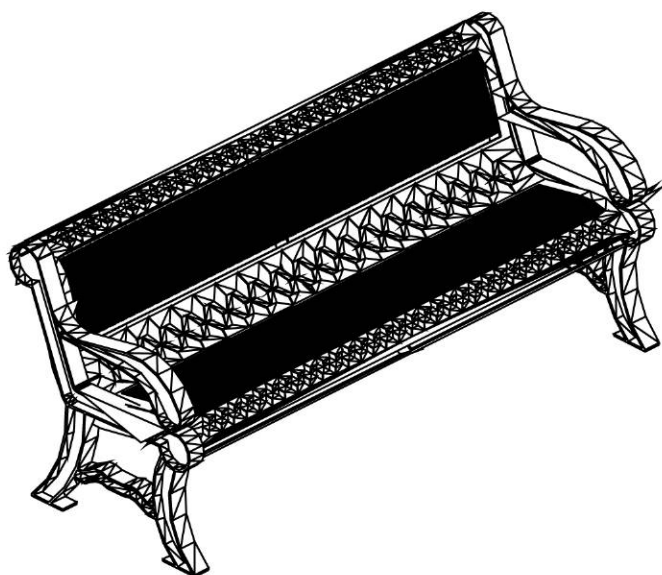

Please take the time to locate and identify each part. Assemble the units on a smooth flat surface. It is also helpful to lay the tops and seats on cardboard or a drop cloth to prevent scratching of the surface during assembly. All parts have been pre-cut and pre-drilled for ease of assembly. All holes are slotted to allow for easy assembly and for final levelling of tops and seats to frames. Fully assemble all parts without totally tightening nuts and bolts. After all assembled go back and retighten nuts to bolts. DO NOT OVER TIGHTEN NUTS TO BOLTS. Over tightened nuts can crack the plastisol coating. All the necessary quantities of parts required are listed in this assembly instructions.

DO NOT BEGIN ASSEMBLY UNTIL YOU HAVE READ THESE INSTRUCTIONS AND ARE FAMILIAR WITH THE PARTS.

# PARTS IDENTIFICATION

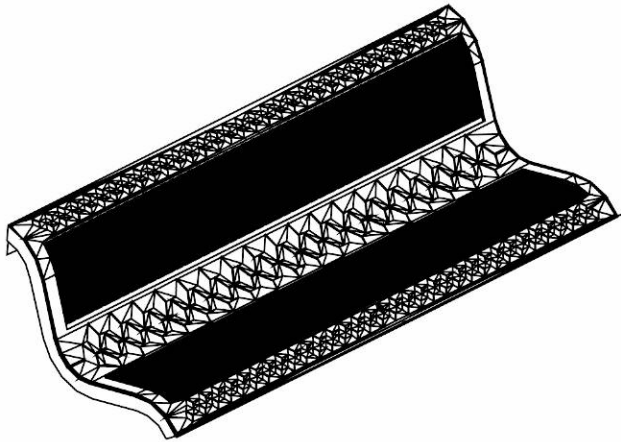

(A) 4' VILLA SEAT

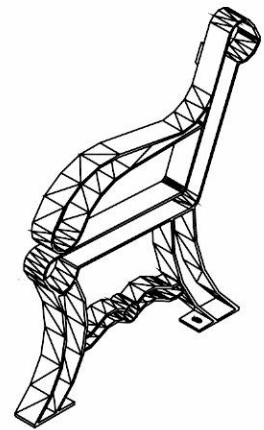

(B) VILLA FRAME

## PARTS LIST

ITEM	PART#	DESCRIPTION	QTY.
A	S4VILLAEXP	6' VILLA EXP SEAT	1
B	FBVILLA	VILLA FRAME	2

ITEM	HARDWARE DESCRIPTION	QTY.
HW1	5/16" X 18 NYL LOCKNUTS	4
HW2	5/16" X 18GA CAP BOLTS	4
HW3	5/16" FLAT WASHERS	8
HW4	BOLT GUARDS	4

ASSEMBLY TOOLS REQUIRED  
2- 1/2" WRENCHES

## HARDWARE IDENTIFICATION



(HW1) 5/16" X 18  
NYL LOCKNUTS



(HW2) 5/16" X 18  
GAUGE CAP BOLTS



(HW3) 5/16"  
FLAT WASHERS



(HW4) BOLT  
GUARDS

# ASSEMBLY PROCEDURES

## STEP 1

SET FRAME ON LEVEL SURFACE.

## STEP 2

MOUNT BENCH SEAT TO FRAME BY LINING UP THE FOUR BOLTS ON THE FRAME TO THE HOLES ON EACH SIDE OF THE SEAT, THEN ATTACH THE 2 DIAGONALS TOGETHER ON THE HOLE IN THE CENTER OF BENCH, THEN PULL THE DIAGONALS DOWN TILL THEY ARE LINED UP WITH THE HOLES ON THE FRAME AND ATTACH. THE DIAGONALS WILL BE FASTENED ON WITH THE  $5/16 \times 1 \frac{1}{2}$  BOLTS. Hand tighten at this time only.

## STEP 3

NOW THAT ALL PARTS ARE ASSEMBLED. SQUARE AND ALIGN ALL PARTS OF THE UNIT THEN TIGHTEN ALL NUTS ON BOLTS SECURELY. DO NOT OVER TIGHTEN AS THIS WILL CAUSE THE PLASTISOL COATING TO CRACK.

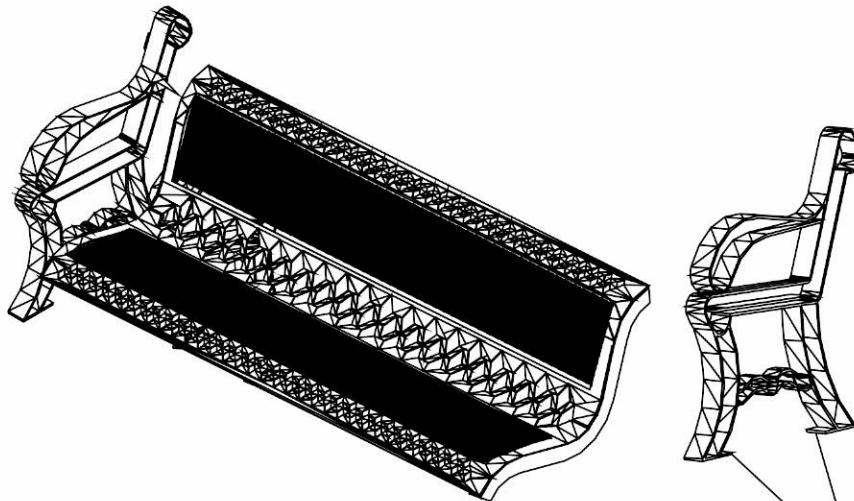

SURFACE MOUNT HOLES  
ARE LOCATED ON THE TABS  
AT THE BOTTOM OF EACH FRAME.  
WITH A CENTER DISTANCE OF  $17 \frac{1}{2}$ "

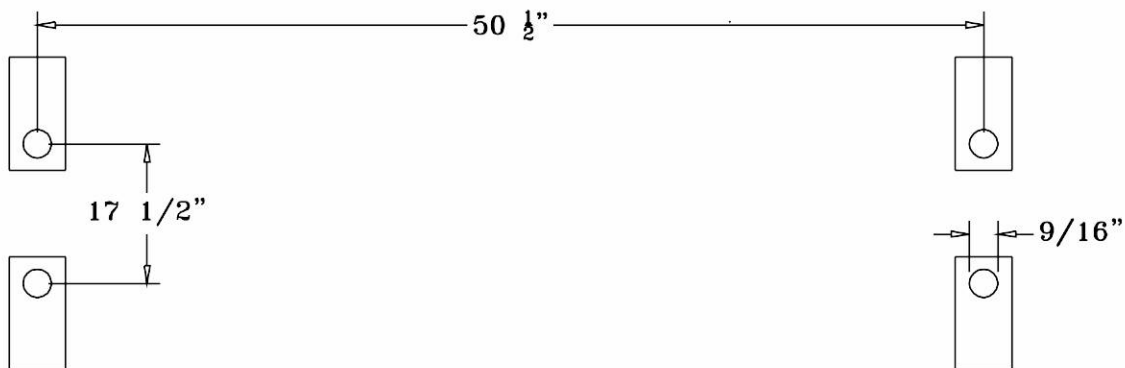

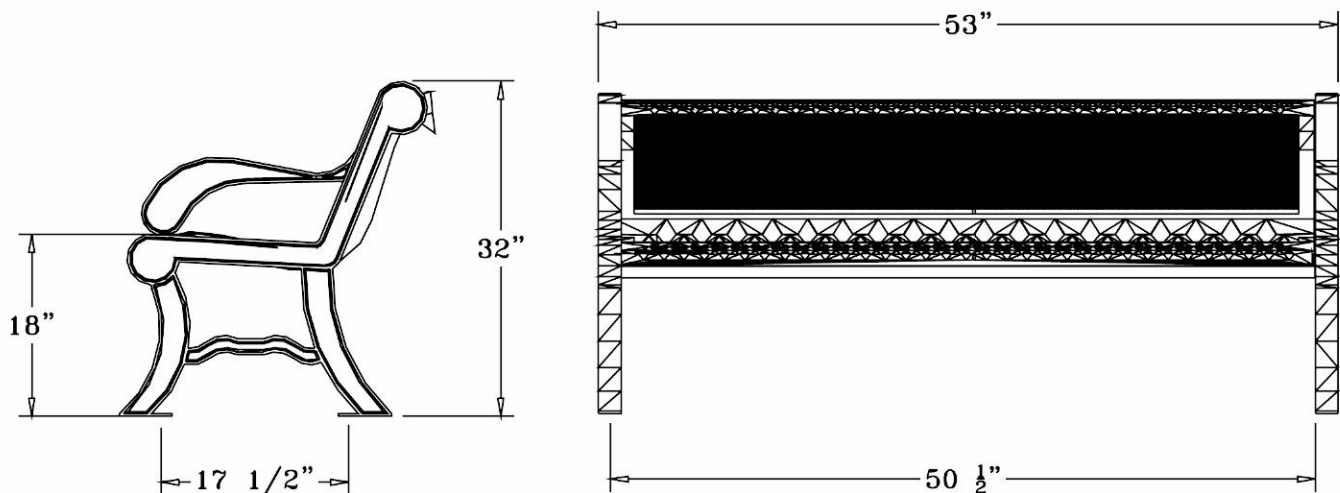

## SPECIFICATIONS

6' POLY VINYL EXPANDED METAL VILLA STYLE BENCH WITH BACK  
THE FRAME IS PORTABLE DESIGN.

COATED WITH A 1/8" TO 1/4" THICK PLASTISOL ULTRAVIOLET STABILIZED VINYL COATING FUSED  
AND BAKED TO A 90% GLOSS.

SEAT HEIGHT IS 18" APPROXIMATELY, BENCH HEIGHT IS 32" APPROXIMATELY.  
TOTAL OVERALL DIMENSIONS ARE 53" X 10 1/2".

SEAT IS MADE BY ROLLING HEAVY DUTY 3/4" #9 EXPANDED METAL INSIDE AN  
CAST ALUMINUM FRAME.

FRAMES ARE MADE OF CAST ALUMINUM. COATED WITH A BAKED  
ON POLYESTER POWDER COAT FINISH.

ALL HARDWARE IS NON-CORROSIVE  
WEIGHT FOR THE B6WBVILLAEXP IS 130 LBS.

## MAINTENANCE

To maintain luster it is recommended to wash, rinse, and dry the units after prolonged use.  
Check for loose bolts and nuts and tighten as needed. Contact the factory for genuine  
Webcoat part replacements if needed.