

TF3125

Concrete table available for Quick Ship in sand color.

ITEM NUMBER:
TF3125

DIMENSIONS
66" dia. x 31"

WEIGHT:
1,100 lbs.

ADDITIONAL FEATURES:

Parts:

- 1 Table top (TF3500)
- 4 Bench tops (TF3499)
- 1 Top leg (TF3623)
- 1 Bottom leg (TF3624)

***Assembly Required**

MATERIAL:

- Concrete

SHAPE:

- Circle

REINFORCEMENT:
Yes

BACK TYPE:

- Without Back

SEATING TYPE:

- Attached

UMBRELLA INSERT:
Yes



Available for Quick Ship in sand color

STANDARD GROUND & POLISH TOP & BENCH - ACID WASH LEGS (W/ BUFF HARDWARE)



G20 White



G21 Buff

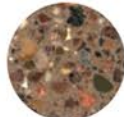

G22 Sand



G24 Brick Red



G25 Brown



Legs - A22
Sand

STANDARD GROUND & POLISH TOP & BENCH - ACID WASH LEGS (W/ GRAY HARDWARE)

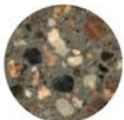

G23 Gray



G26 Charcoal



Legs - A23 Gray



Furniture Leisure
Commercial Site Furnishings

1-800-213-2401 | sales@furnitureleisure.com

FurnitureLeisure.com
PicnicFurniture.com
ParkTables.com

PoolFurnitureSupply.com
PicnicTableSupplier.com
UBrace.com

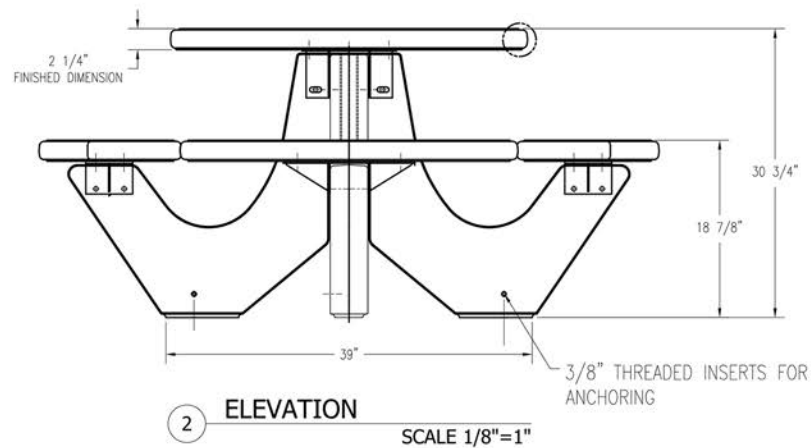
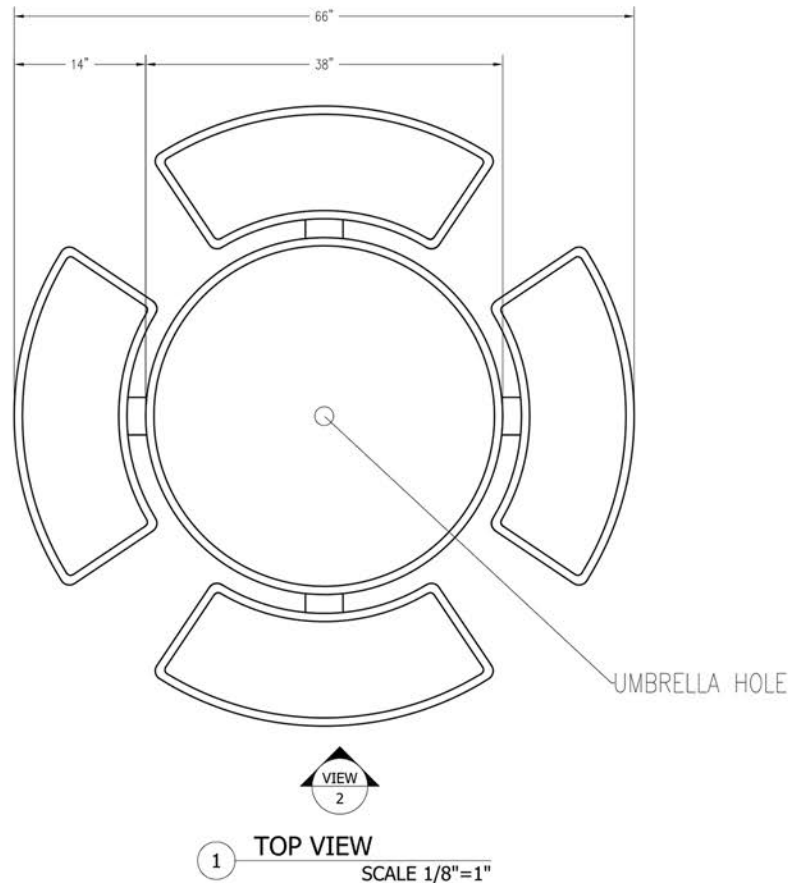

SIGN BELOW IF DRAWINGS ARE
APPROVED W/ MARKED CHANGES

APPROVED: _____

DATE: _____

(SIGNATURE ABOVE ILLUSTRATES ACCEPTANCE OF DIMENSIONS SHOWN.)

REVISIONS		
NAME	DATE	NOTES
1		
2		
3		
4		
5		
6		
7		
8		

CONFIDENTIAL INFORMATION
THESE DRAWING, SPECIFICATIONS AND OTHER INFORMATION AND DOCUMENTS ACCOMPANYING THEM ARE THE CONFIDENTIAL AND PROPRIETARY PROPERTY OF WAUSAU TILE, INC. THE DRAWINGS THEMSELVES SHALL BELONG TO THE OWNER FOR USE ONLY ON THE PROJECT. ANY ADDITIONAL USE SHALL REQUIRE THE PRIOR WRITTEN APPROVAL OF WAUSAU TILE, INC. THE PROPRIETARY INFORMATION CONTAINED WITHIN THE DRAWINGS AND THE DOCUMENTS IS AND SHALL REMAIN THE SOLE PROPERTY OF WAUSAU TILE, INC

UNLESS OTHERWISE SPECIFIED
DIMENSIONS ARE IN INCHES
FRACTIONS ± 1/8"

DRAWN BY: TAS

DATE: 3/8/17

CO. NUMBER: .

WEIGHT:

SHEET NO.

TF3125