

USER GROUP: All Ages

RECOMMENDED CREW: 1-2 People

TOOLS REQUIRED:

- T-30, TT-45 Torx
- Level, Square, Wood Saw
- Auger / Post Hole Digger / Shovel
- Drill Bits: 7/32", 7/16"
- Framing, Bracing, or Concrete Forms (Not Included)
- High Speed 3/8" Electric Drill with Clutch

NOTE: Use of any other driver may result in damage to tool and/or hardware!

NOTE: Use Thread Locking Solution on ALL Non-Patched Hardware with Threads!

INSTALLATION TIME: 1 Hour

WEIGHT: 369 lbs.

CONCRETE REQUIRED: (3 or 7) 80lb. bags  
1.7 ft<sup>3</sup> or 4.0 ft<sup>3</sup>

NOTE: Concrete must have a minimum rating of 2,500 psi and must be mixed per manufacturer's recommendations.

#### PRE-INSTALLATION CHECK:

**Customer is responsible** for verifying materials received by comparing received items with packing list. If any parts are missing or damaged, including documentation, contact your local sales representative immediately.

**Supplier is not responsible** for items discovered missing after 72 hours from time of delivery.

**Before beginning installation, all installers must read and understand the Installation Introduction manual as supplied.** If you did not receive a copy, or if you have any questions regarding any information in the Installation Instructions or this Installation Guideline, contact your local sales representative.

ITEM	Part No.	QTY	DESCRIPTION
1	166796	1	Flanged 30" Diameter Crawl Tube - 90 Degree Elbow without lip and with round spy holes on seam
2	166797	1	Flanged 30" Diameter Crawl Tube - 90 Degree Elbow with lip and with round spy holes on seam
3	RSP-4981XX	2	Sheet - 2018 Dog Park Flanged Tube Attachment Panel
4	REA00256XX	2	Pre-Assem - 6" x 6" x 74" Recycled post w/ Cap
5	REA00255XX	2	Pre-Assem - 6" x 6" x 64" Recycled post w/ Cap
6	HWB0210	36	Bolt 3/8"-16 x 1" TORX Security with Patch
7	HWWR0096	36	Washer 3/8" ID x 7/8" OD x 0.11 thick Flat SS
8	HWWR0083	36	Washer 3/8" Split Lockwasher 316SS
9	HWN0128	36	Nut 3/8"-16 302 SS TORX Barrel
10	HWS0301	14	Screw 5/16" x 3-1/8" RSS SS

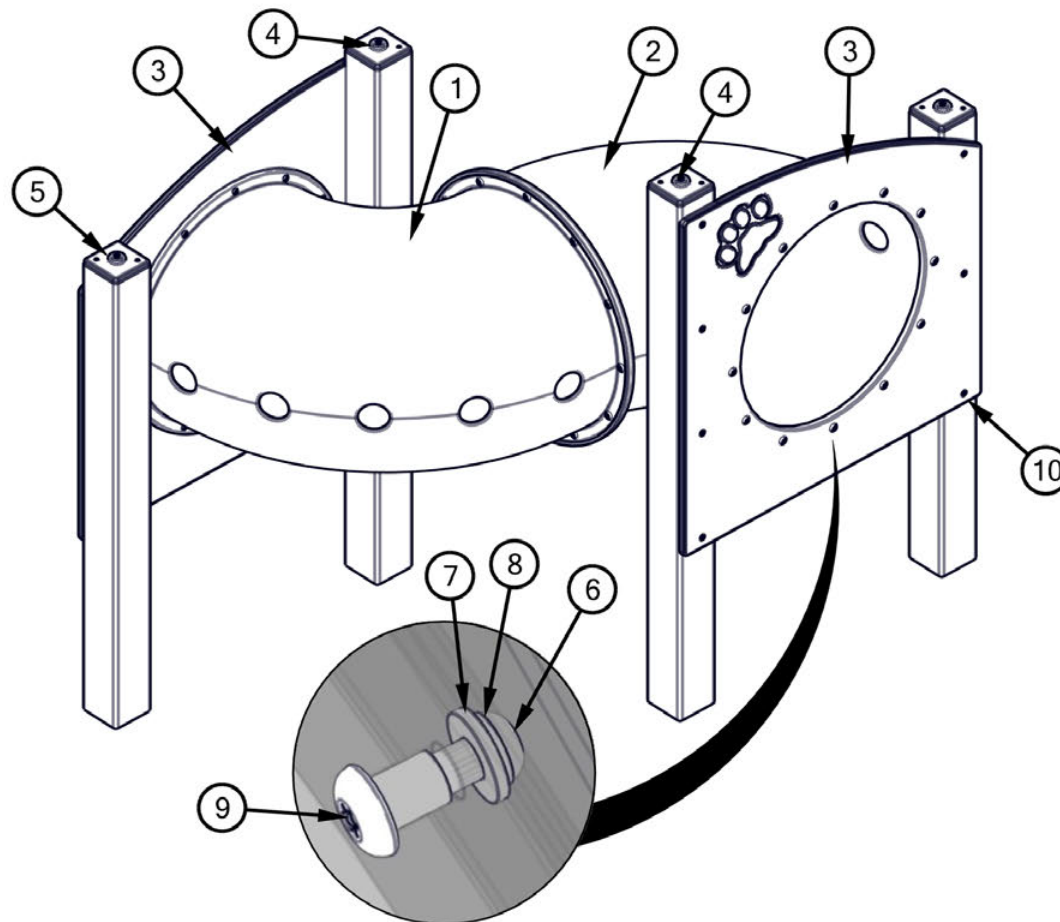

## STEP 1

Determine depth for setting support posts. Recommended minimum depth of support posts is 12". If support posts are set at 12" depth, cut off 12" from each support post. If support posts are set at 24" depth, support posts do not require modification.

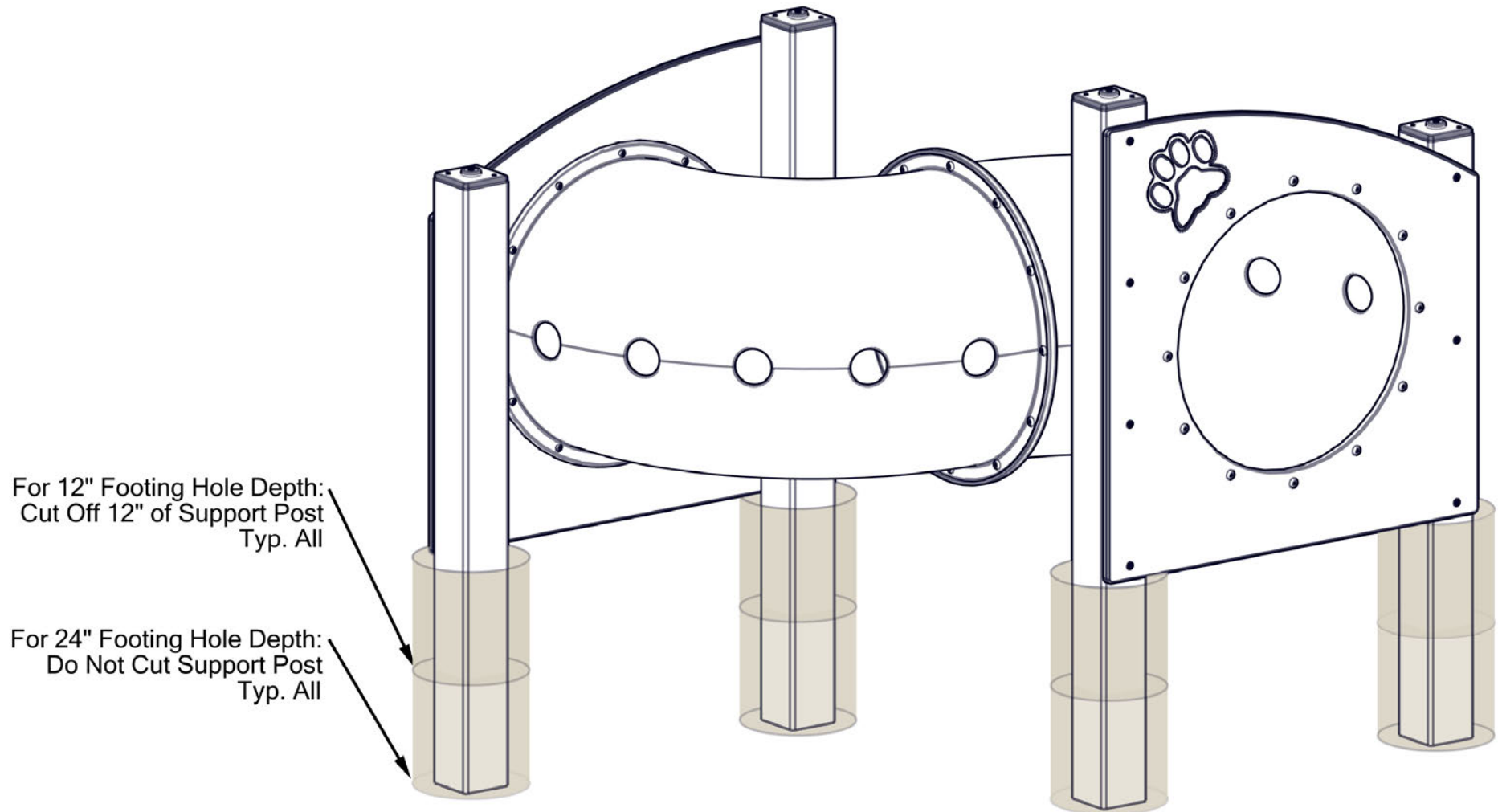

# INSTALLATION GUIDELINE

## STEP 2

Mount panels to end flanges on elbo tubes. Holes in tube should be horizontal. Align holes in panel with holes in flange. Insert twelve (12) 3/8" security barrel nuts into panel. Secure flange to panel with twelve (12) 3/8" x 7/8" flat washers, twelve (12) 3/8" lock washers, and twelve (12) 3/8" x 1" security Torx. See Detail 2-1 for common connection. Repeat for opposite panel and flange. Align holes in open ends of elbow tubes. Match drill twelve (12) 7/16" through-holes through flange with lip and flange without lip. Secure elbows together with twelve (12) 3/8" x 7/8" flat washers, twelve (12) 3/8" lock washers, and twelve (12) 3/8" x 1" security Torx.

### Detail 2-1

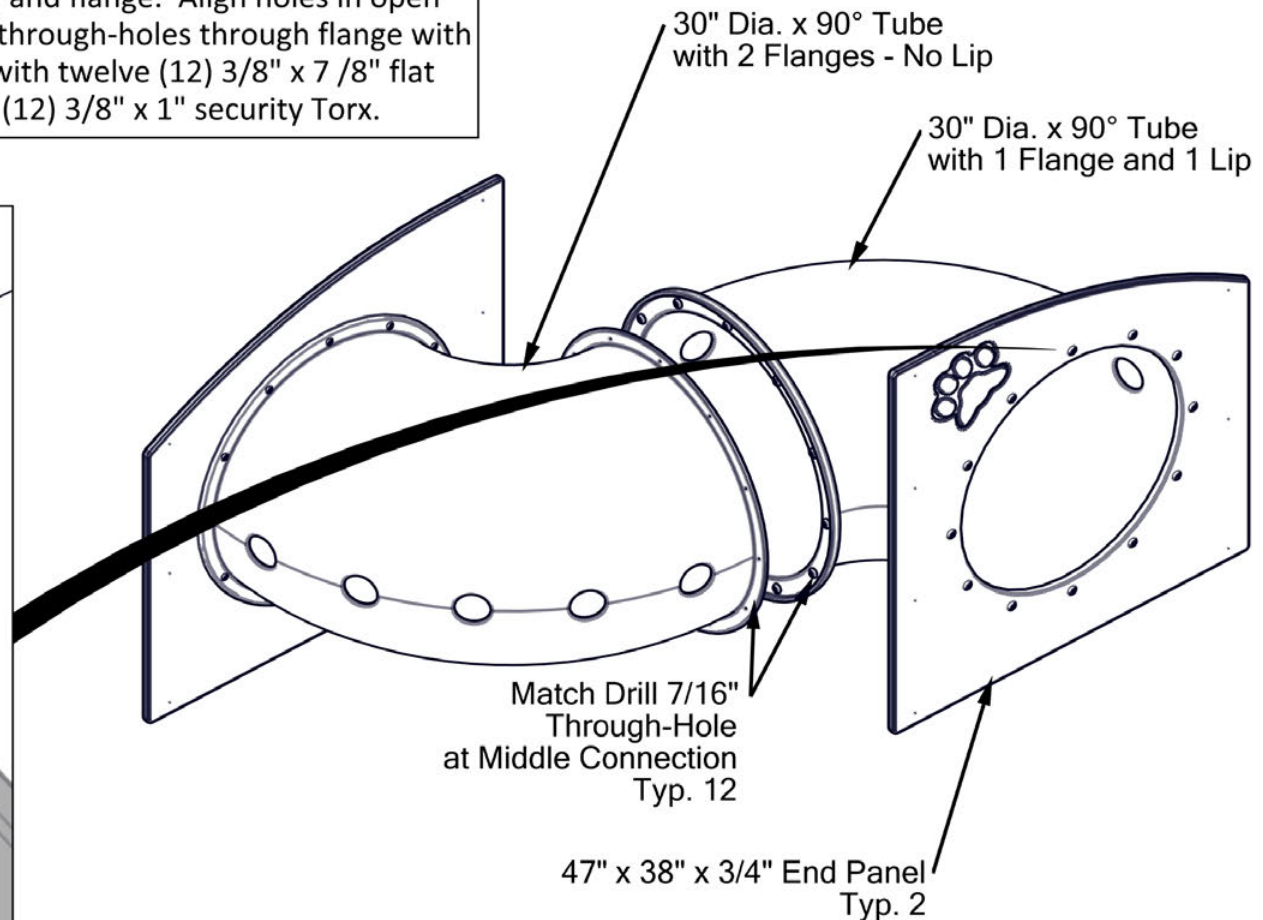
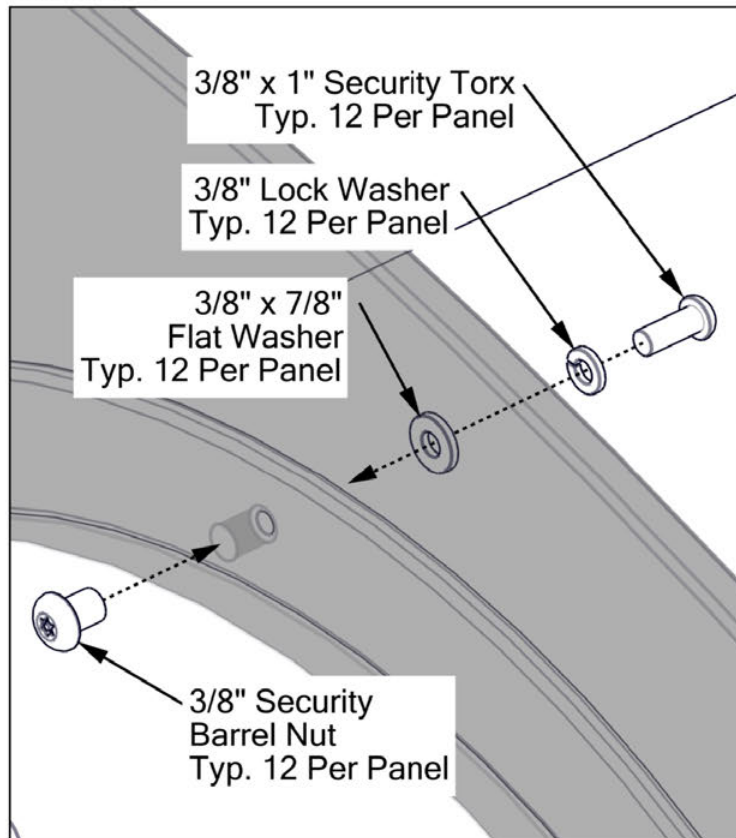



## STEP 3

Mount support posts to tunnel panels. Support posts should be on side of panel facing tunnel. Outer edges of panels should be flush with sides of support posts. All support posts should be 24" from bottoms of panels (12" if support posts have been cut). Ensure support posts are square. At each panel, drill seven (7) 7/32" pilot holes through pre-drilled holes in panel and into support posts. Secure with seven (7) 5/16" x 3-1/8" RSS. Ensure support posts are square.

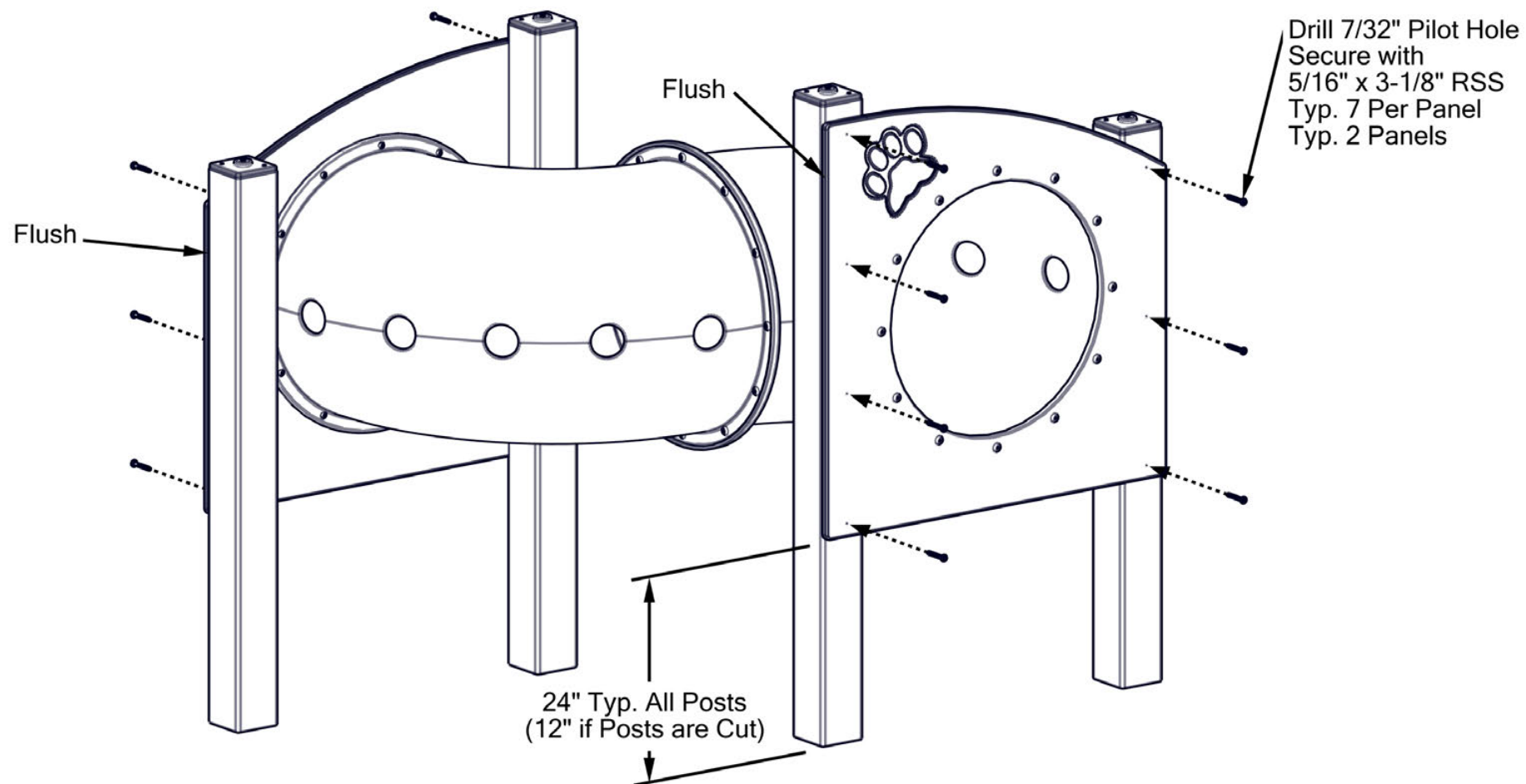

# INSTALLATION GUIDELINE

## STEP 4

Set support posts. Refer to site plan drawing and site elevation drawing for placement of all support posts. Installer is responsible for proper location of all support posts. See Detail 4-1 for support post spacing. Footing holes for support posts must be a minimum of 12" diameter and 12" deep. Footing holes should be 24" deep if support posts aren't cut. Place assembly into footing holes and plumb. Fill each footing hole with concrete to within 3" from ground surface. Allow concrete to cure based upon manufacturer's instructions. Backfill each footing hole with dirt, flush with grade. See Detail 4-2. Installation is complete.

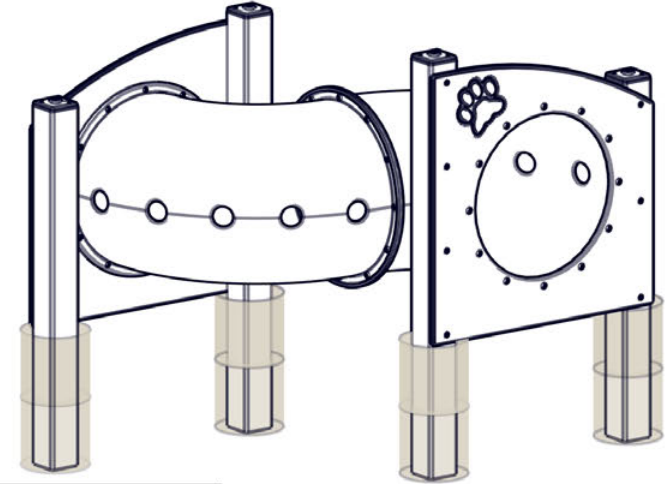

Detail 4-1

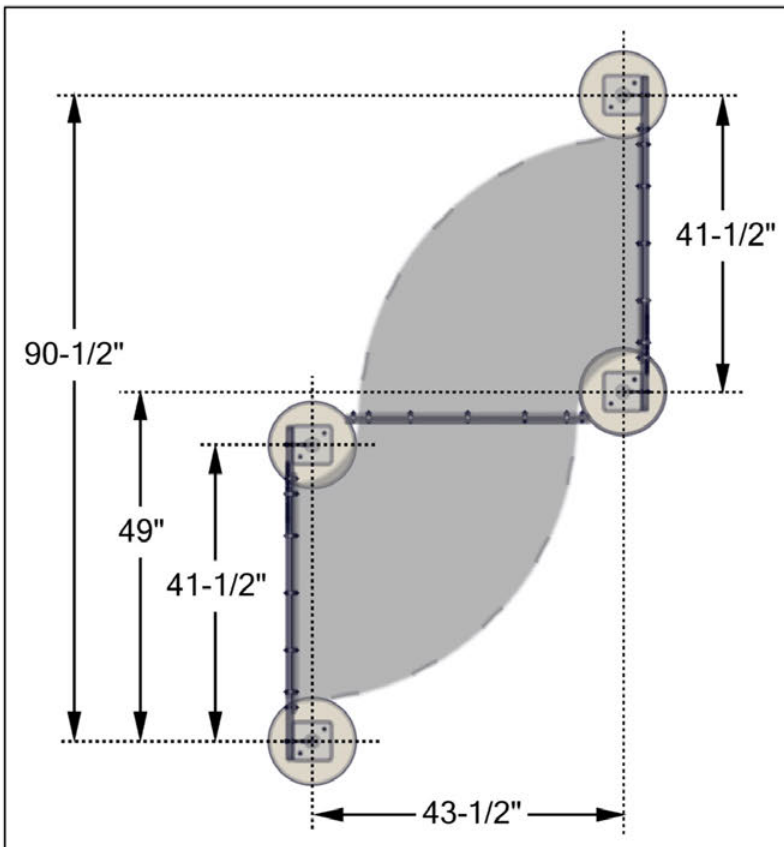

Detail 4-2

