

USER GROUP: All Ages

RECOMMENDED CREW: 2 People

TOOLS REQUIRED:

- TT-45, T-25 Torx
- Level, Square, Wood Saw
- Auger / Post Hole Digger / Shovel
- Drill Bits: 7/32"
- Framing, Bracing, or Concrete Forms (Not Included)
- High Speed 3/8" Electric Drill with Clutch

NOTE: Use of any other driver may result in damage to tool and/or hardware!

NOTE: Use Thread Locking Solution on ALL Non-Patched Hardware with Threads!

INSTALLATION TIME: 1 Hour

WEIGHT: 104 lbs.

CONCRETE REQUIRED: (1.5 or 3.3) 80lb. bags  
0.9 ft<sup>3</sup> or 2.0 ft<sup>3</sup>

NOTE: Concrete must have a minimum rating of 2,500 psi and must be mixed per manufacturer's recommendations.

#### PRE-INSTALLATION CHECK:

**Customer is responsible** for verifying materials received by comparing received items with packing list. If any parts are missing or damaged, including documentation, contact your local sales representative immediately.

**Supplier is not responsible** for items discovered missing after 72 hours from time of delivery.

**Before beginning installation, all installers must read and understand the Installation Introduction manual as supplied.** If you did not receive a copy, or if you have any questions regarding any information in the Installation Instructions or this Installation Guideline, contact your local sales representative.

ITEM	Part No.	QTY	DESCRIPTION
1	AFB-31427XX	1	Wldmt - 1.25" OD x 35-11/16" w/ weld nuts in ends
2	REA00254XX	2	Pre-Assem - 6" x 6" x 54" Recycled post w/ Cap
3	RSP-2110XX	1	Sheet - R3 Limbone Anyone Track Panel (Side B)
4	RSP-2109XX	1	Sheet - R3 Limbone Anyone Track Panel (Side A)
5	HWS0296	20	Screw - 10 x 2-1/2" R4 SS
6	HWM0363	2	Misc. - .75" OD x .78" Delrin Guide
7	HWWR0092	2	Washer 3/8" ID x 1-1/4" OD Flat SS
8	HWB0222	2	Bolt - 3/8" x 1-1/2" Security Torx With Patch

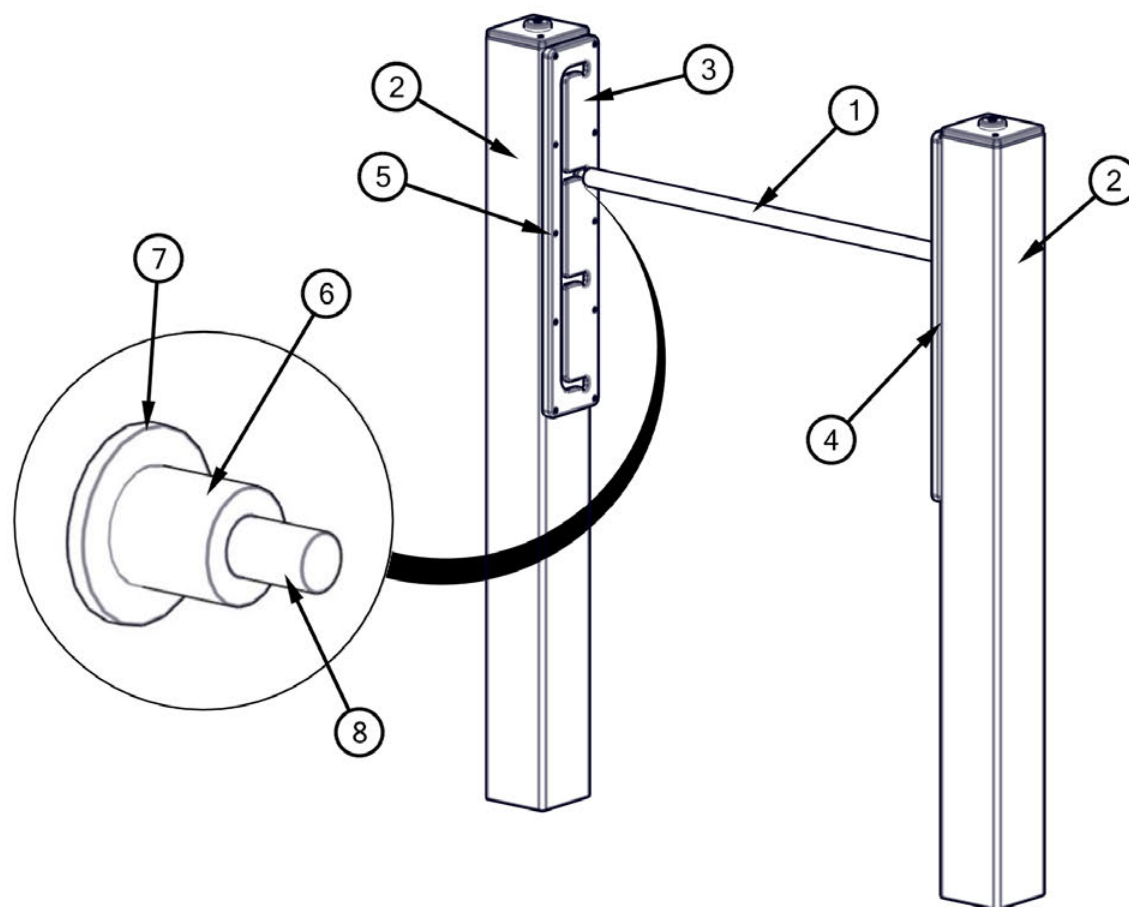

## STEP 1

Determine depth for setting support posts. Recommended minimum depth of support posts is 12". If support posts are set at 12" depth, cut off 12" from each support post. If support posts are set at 24" depth, support posts do not require modification.

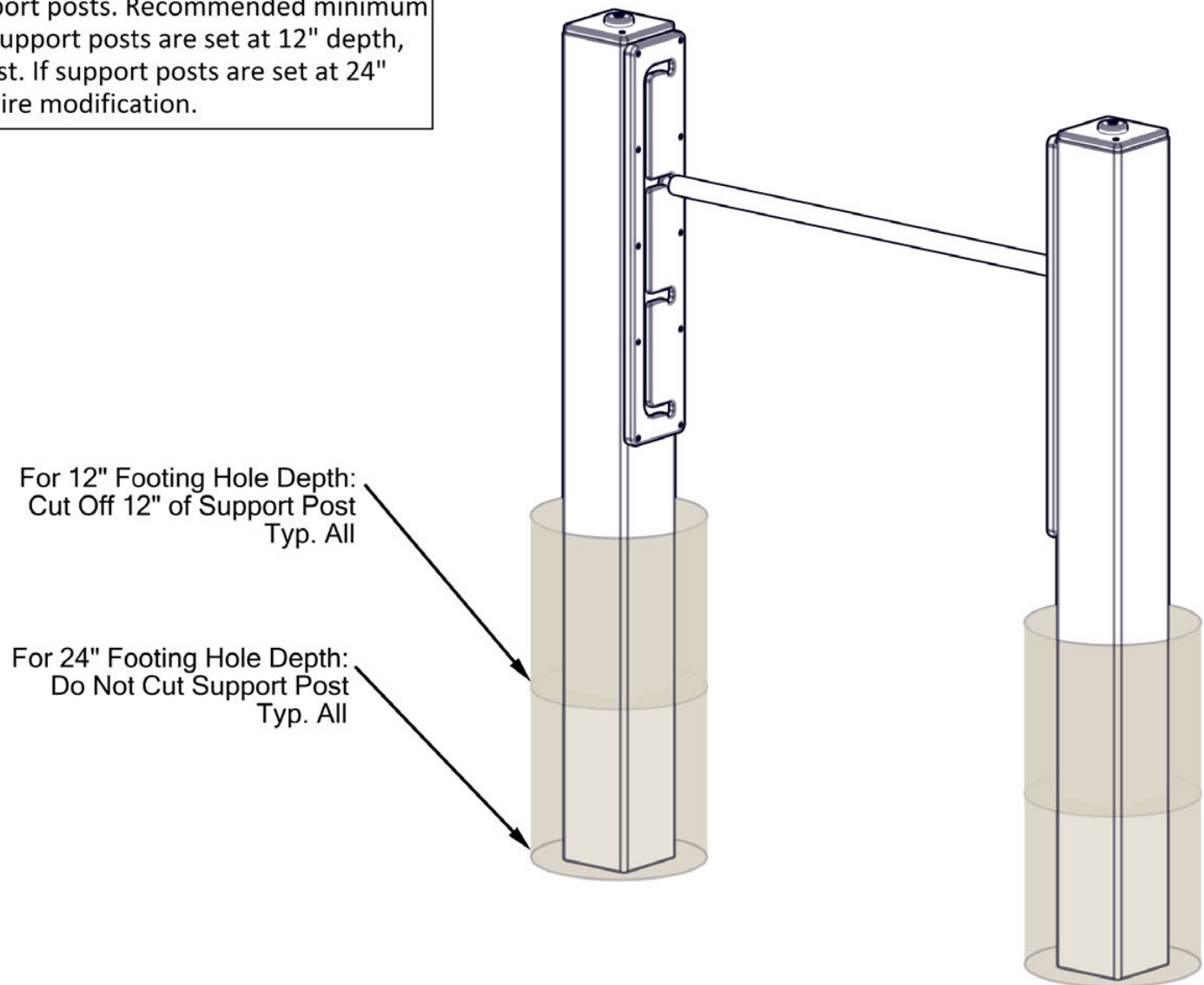

# INSTALLATION GUIDELINE

## STEP 2

Assemble cross bar with track panels. Place track panels at ends of cross bar. Ensure recessed side of panels face away from cross bar. Ensure notches in track panel point downward. Cross bar will not fit in groove. At each end of cross bar, secure one (1) 3/4" x 7/8" Delrin guide and one (1) 3/8" x 1-1/4" flat washer with one (1) 3/8" x 1-1/2" security Torx. See Detail 2-1 for assembly method and Detail 2-2 for assembled view. Repeat for opposite end of cross bar.

### Detail 2-1

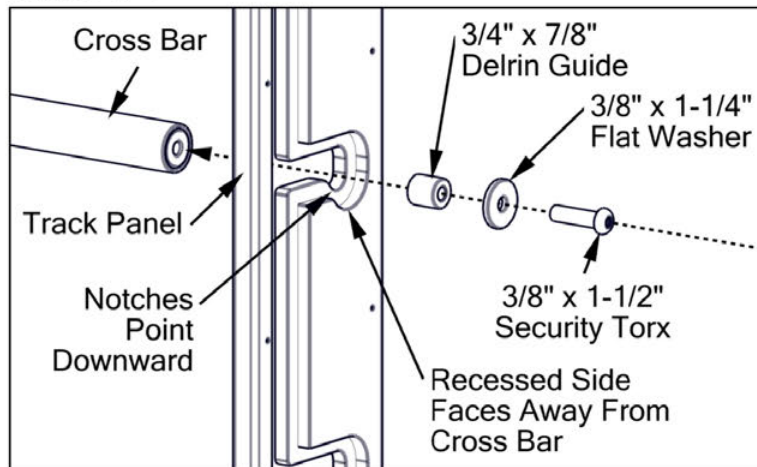

### Detail 2-2

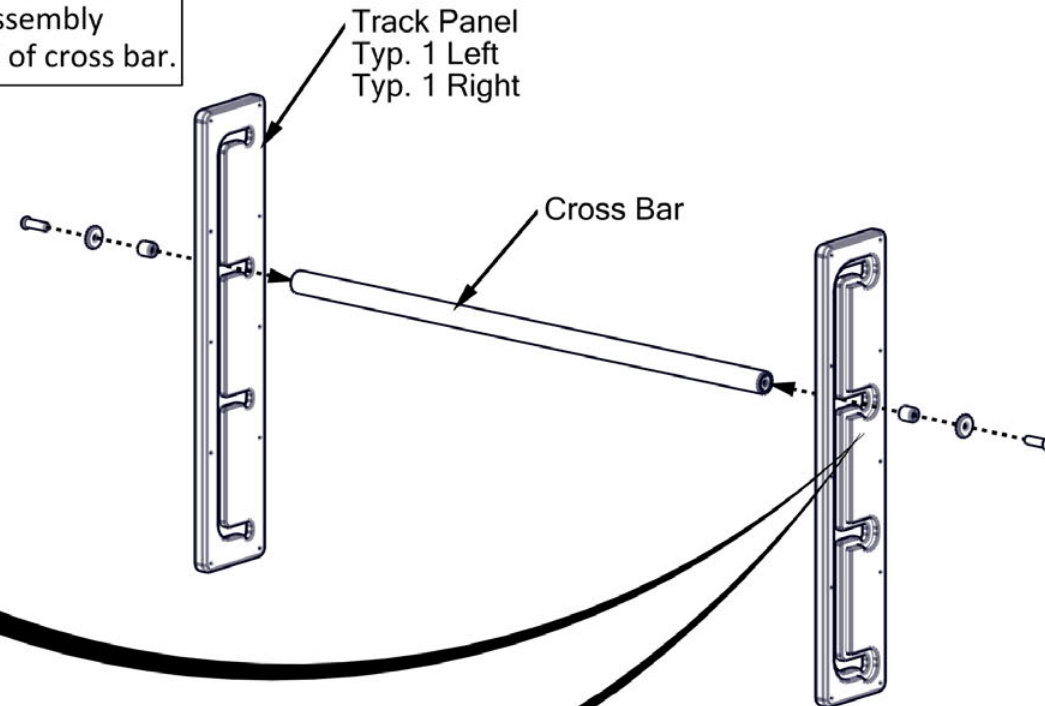
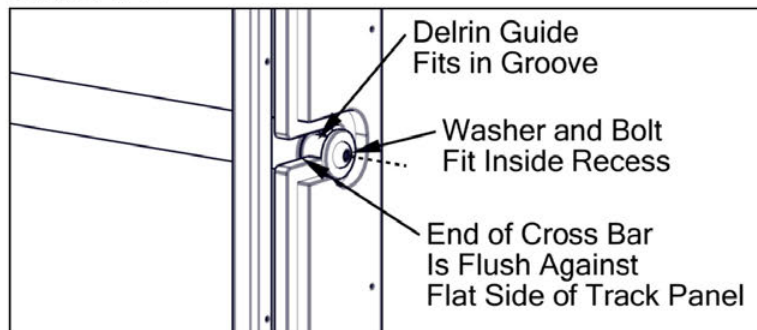

## INSTALLATION GUIDELINE

### STEP 3

Mount track panels to support posts. Top end of panels should be flush with top ends of support posts. Sides of panels should be flush with sides of support posts. Ensure panels are square. At each panel, drill ten (10) 1/8" pilot holes through pre-drilled holes in panel and into support post. Secure with ten (10) #10 x 2-1/2" R4. See Detail 3-1. Repeat for opposite panel.

### Detail 3-1

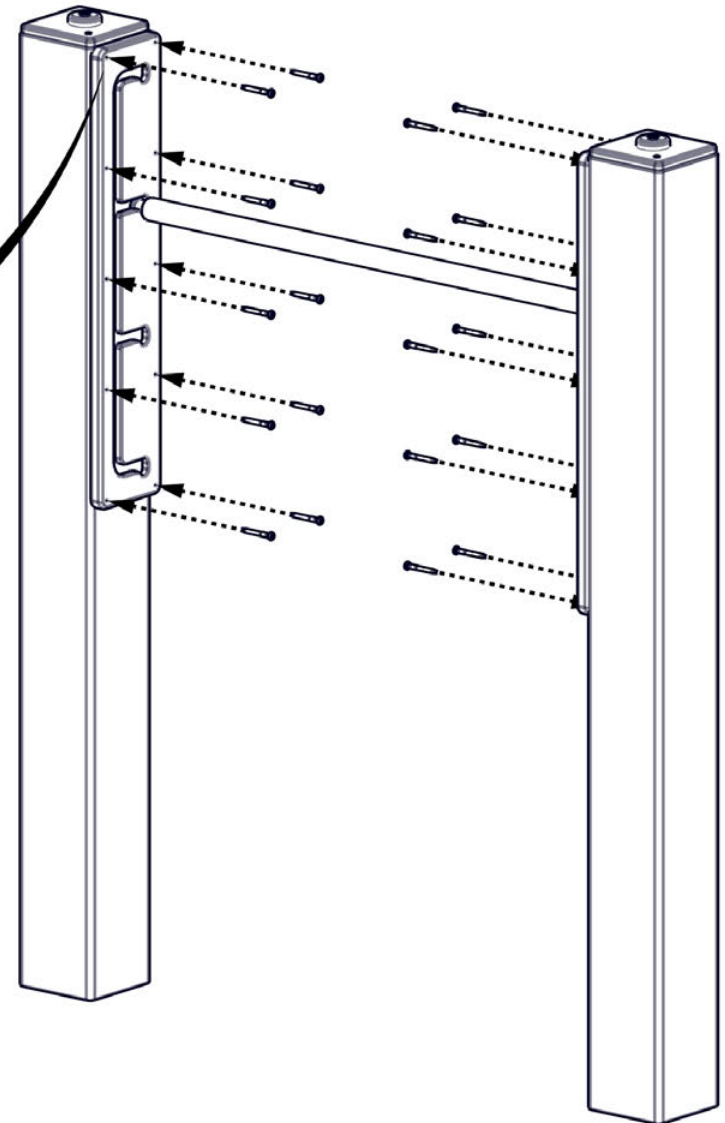
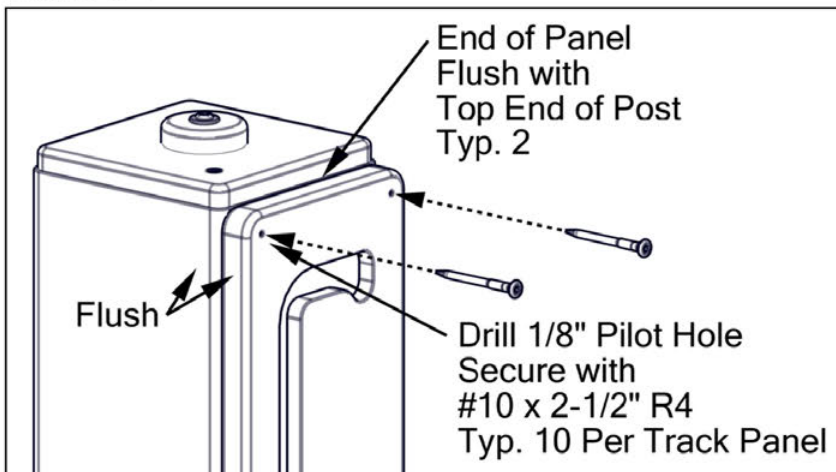



# INSTALLATION GUIDELINE

## STEP 4

Set support posts. Refer to site plan drawing and site elevation drawing for placement of all support posts. Installer is responsible for proper location of all support posts. Support post spacing is shown at right. Cross bar should move freely when posts are installed. **DO NOT SET POSTS TOO CLOSE TOGETHER.** Footing holes for support posts must be a minimum of 12" diameter and 12" deep. Footing holes should be 24" deep if support posts aren't cut. Place assembly into footing holes and plumb. Fill each footing hole with concrete to within 3" from ground surface. Allow concrete to cure based upon manufacturer's instructions. Backfill each footing hole with dirt, flush with grade. See Detail 4-1. Installation is complete.

Detail 4-1

